

• To Be Determined By Curb Manufacturer

Plan View

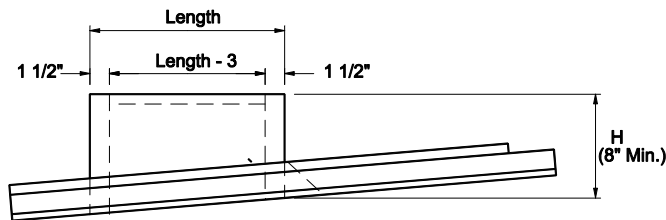

Side View

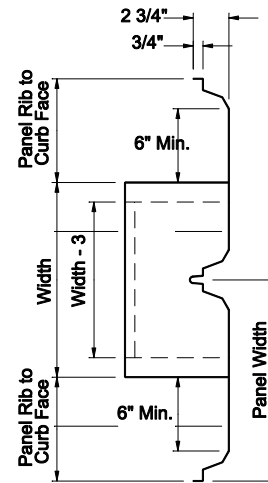

End View

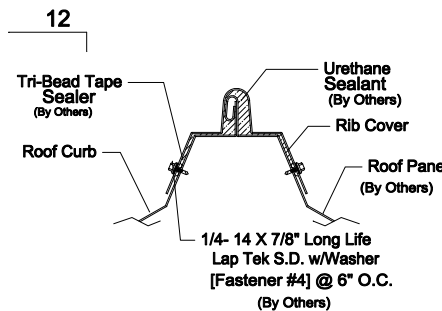

Rib Cover Attachment

* Recommended for use on New Roof only

Standard Requirements

- * .080 Aluminum Construction
- * Corners Mitered and Welded Watertight
- * Welded Cap Cells (Fixed or Loose)
- * Integral Water Diverter
- * 8" Minimum Curb Height
- * 1 1/2" Thick Fiberglass Insulation
- * Under - Over Application
- * Rib to Rib Application
- * Rib Covers - Full Length Plus 1'-0"
- * 20 Year Material and Fabrication Warranty from Curb Manufacturer

Options

- * Galvanized, Galvalume, Stainless Material
- * Metal Liner
- * Damper Shelf
- * Decorative Enamel Finish

MRSR-T Style may be required for trapezoidal Standing Seam Panels by following manufacturers

- * MBCI
- * American Buildings
- * A & S Building Systems
- * Ceco Building Systems
- * Heritage Building Systems
- * Mesco Building Solutions
- * Metallic Building Company
- * Star Buildings
- * Robertson Building Systems
- * Steel Systems
- * Steel Building dot Com
- * Mid - West Steel Building Company
- * All American Systems
- * Garco Building Systems

Specifications and Dimensions							Roof Panel Information			 ACME MANUFACTURING CORP. 6532 TOWER LANE, CLAREMORE, OK 74019 Phone (918) 266-3097 Fax (918) 266-3091 <small>ENGINEERED PRODUCTS BY CRAFTSMEN</small>
Reference	Qty	L (Pitched)	W	H	Pitch	Options	Manufacturer	Type	On Center	
PROJECT									CONTRACTOR	
LOCATION									SUBMITTED BY	
ARCHITECT									DATE	
ENGINEER									PO#	